

Search:

[sitemap](#)

38mm Beam Enhancement Components

REFLECTIVE BEAM EXPANDER/COLLIMATOR Part #: RBE

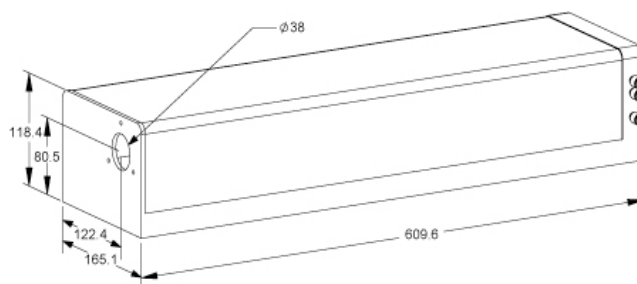

Series Features:

- Interlocked Housing
- Easy removal of optics without re-alignment
- Provides a method of enlarging, reducing, or collimating a laser beam's diameter
- May be used as a beam expander to increase the laser beam diameter on the focus lens which produces smaller spotsizes on the workpiece. Larger beam diameters also decrease power density on internal optics
- May be used as a beam reducer to reduce the laser beam's diameter on the focus lens which produces larger spotsizes on the workpiece. Smaller beam diameters also allow the laser beam to pass through smaller clear apertures
- May be used as a collimator to correct any excessive divergence that may occur over long distances
- Variable beam expansion & reduction options
- Standard mount & enclosure enables all beam expansion or reduction options to be implemented without reconfiguring existing beam delivery system
- Removable cover allows quick access for alignment without disassembly of beam delivery system
- All internally direct cooled reflective optics
- 2 Gimbal & 1 Linear Mirror mounts provide easy alignment
- Optical rail configuration
- water cooling option
- Modular design
- Z-Fold optical configuration
- 15kw power handling capability

Part Numbering Anatomy

